

Wood-Aluminium Systems  
**GUTMANN MIRA therm 08**



# GUTMANN MIRA therm 08

## ► System Description

- Very good thermal insulation technical properties
- The system is assembled on the standard MIRA wood cross section
- In combination with a triple-glazed pane ( $U_g = 0.7 \text{ W/m}^2\text{K}$ ) and a 68 mm or 78 mm wood cross section (fir frame material) that only requires addition of an insulating core in the frame, the further development of the MIRA therm 08 is passive house certified
- The structure is based on the principle of a rear-ventilated attachment shell secured by a PVC bracket
- The thermally insulated MIRA therm 08 system profiles may be ordered in production lengths (6,000 mm) or as frames with welded or punched corner connections

## ► System Cross Section

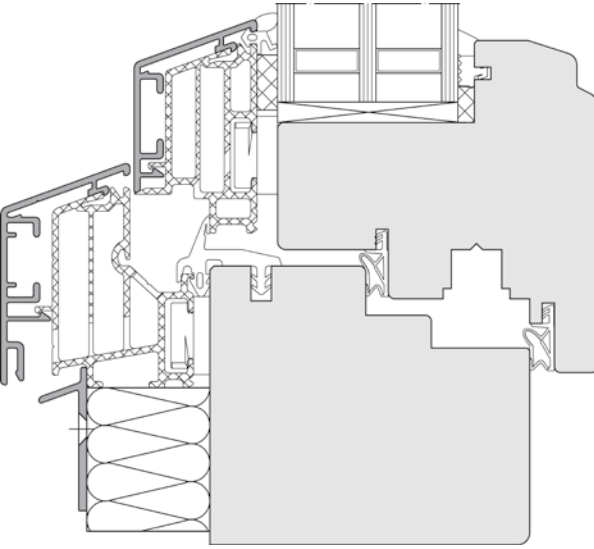

## ► System Properties of Classes



Water tightness

**9 A**



Air permeability

**C2/B3**



Wind load

**4**



Impact resistance

**4**

Test sample: Double-sashed tilt & turn window with operable center section (2200 mm x 2200 mm)  
Test report 102 38329/1

## ► Thermal Insulation



<sup>1</sup> Element size: 1230 x 1480 mm; wood species: Spruce; wood thickness: 68 mm  
Ug value: 0.6 W/m<sup>2</sup>K; Glass spacer: Swisspacer Ultimate