

Window Series  
GUTMANN S70v+



# GUTMANN S70v+

## System Description

Standard window in the 70 mm series with concealed sash and good Insulation of  $U_f = 2.1 \text{ W/m}^2\text{K}$

- Symmetrical, stable structural design with identical corner and T connectors
- Thermally and structurally optimised winglet insulators with high-strength PA 6.6 fiberglass technology
- Glass bead made from reinforced PA 6.6
- Euro groove for free choice of hardware
- Surface mounted fittings up to sash weights of 170 kg; concealed fittings up to 150 kg
- Face width from 71 mm for tilt & turn windows
- Use of glass up to 46 mm in sash
- Soundproofing up to 47 dB (SSK 5)

## System Cross Section

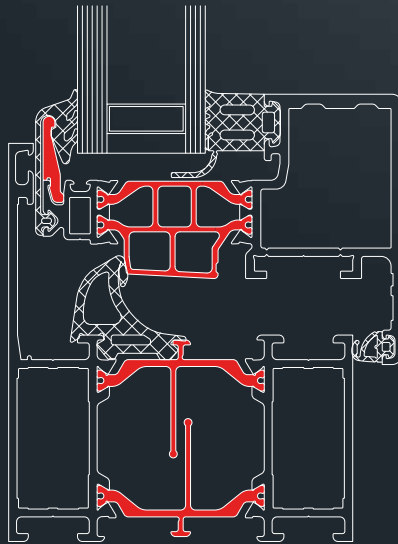

## System Properties of Classes



Water tightness

**E 1200**



Wind load

**C5/B5**



Air permeability

**4**



Operating forces

**2**

PB 10-00509-PB03-A01-0203-de-01; Element size: 2278 x 2472 mm (double sash french window)

## Thermal Insulation



<sup>1</sup> Psi value: Thermix TX.N 0.045 W/mK; Ug value: 1.0 W/m<sup>2</sup>K; Element size: 1230 x 1480 mm